

# Public Auction

**NAZARENE CHURCH & PARSONAGE IN ERICK, OK  
AND ACREAGE AND MINERALS IN TEXOLA, OK**

**SATURDAY, DECEMBER 2, 2017 10:00 A.M.**

**SALE LOCATION:** Beckham County Activity Barn, Sayre, Oklahoma (Located east of the Historic Beckham County Courthouse)

**AUCTIONEER'S STATEMENT:** It is an honor to conduct the auction of the Nazarene Church and the Nazarene Parsonage in Erick, Oklahoma. The Southwest Oklahoma District Church of the Nazarene has made the decision to sell the Former Nazarene Church and the house formerly the Nazarene Parsonage at public Auction. We invite you to attend this special auction.

Open House Sunday, Nov. 26, 2017 • 1-3 pm  
or by appointment 405-831-3718 or 580-225-6743

**TRACT 1:** 402 South Elm, Erick, Oklahoma

**PROPERTY DESCRIPTION:** This 1300 square foot house that is on a corner lot has a kitchen, living room, 3 bedrooms, 1.5 bathrooms, utility room and a 2 car carport. This would be a good starter home or a good investment property with numerous opportunities.

**TRACT 2:** 501 South Maple, Erick, Oklahoma

**PROPERTY DESCRIPTION:** This 5630 square feet commercial building formally the Nazarene church, has 2 central heat and air units and a metal roof. A large sanctuary, large meeting rooms, 2 class rooms, kitchen and 2 bathrooms. It has numerous possibilities as a church, investment property or a commercial property with unlimited possibilities.

**REAL ESTATE TERMS:** 15% of the purchase price will be placed in escrow day of sale. Property will be conveyed by Warranty Deed. Possession will be at closing. All measurements are approximate.

**BROKER PARTICIPATION INVITED:** Broker must pre-register client 48 hours in advance of auction.

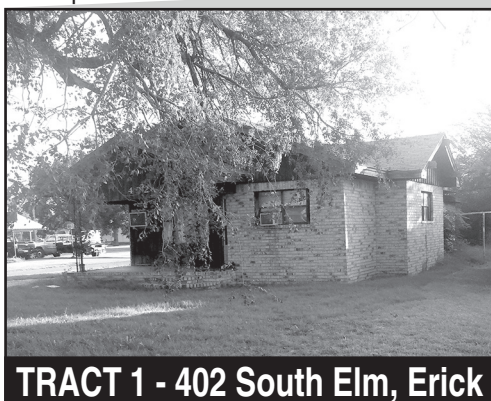

**TRACT 1 - 402 South Elm, Erick**

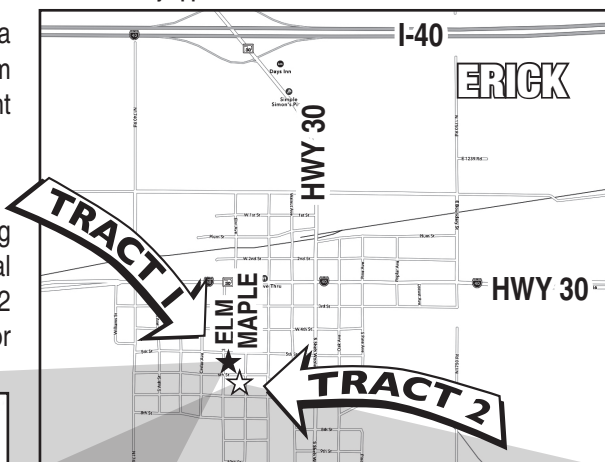

**TRACT 2 - 501 South Maple, Erick**



## SOUTHWEST OKLAHOMA DISTRICT CHURCH OF THE NAZARENE

**AUCTIONEER'S STATEMENT:** It is a privilege to conduct the auction of 5 acres of real estate near Texola, Oklahoma on Historic Route 66 Highway and 5 acres of mineral interests located north of Texola in Beckham County, Oklahoma. Both the real estate and mineral interests will be conveyed by quit claim deed

**TRACT 1:**

**PROPERTY DESCRIPTION:** 5 Acres m.o.l. of land currently in Bermuda grass lying adjacent to and East of Block 15 of the Town of Texola, Beckham County, Okla (Surface Only) Watch for auction signs.

**TRACT 2:**

**PROPERTY DESCRIPTION:** 5 Acres M.O.L. of mineral interest located in Lots 2, 6, 7, and 8, and the SE/4 of NW/4, and SW/4 of NE/4 of Section 31, Township 10 North, Range 25 W.I.M., Beckham County, Oklahoma.

**REAL ESTATE TERMS:** 15% of the purchase price will be placed in escrow day of sale. Property and Minerals to be conveyed by quit claim deed. Possession will be at closing. All measurements are approximate.

**BROKER PARTICIPATION INVITED:** Broker must pre-register client 48 hours in advance of auction.

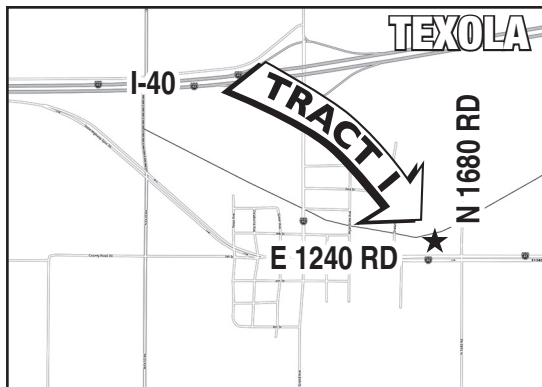

**EVERETT GALE DORRELL**



## Gene Cobb Auction & Realty

**Richard E. Cobb, CAI, AARE • Auctioneer/Real Estate Broker • Certified Appraiser**

**580-225-6743 • P.O. Box 982 • Elk City, Oklahoma 73648**

**Rhett D. Cobb • Licensed Auctioneer • Real Estate Broker - Texas & Oklahoma**

**806-206-1554 • P.O. Box 763 • Canyon, Texas 79015 • Texas Broker # 0549348 • TDLR # 16204 • Oklahoma Broker # 142951**

We Act As Agents & Agents Only • Not Responsible For Accidents • Any Announcements Made Sale Day Supersede All Other Announcements

Every effort has been made to assure the accuracy of the information with no guarantee of authenticity.

**VISIT US ON THE WORLD WIDE WEB FOR A SCHEDULE OF UPCOMING AUCTIONS  
AND TO VIEW MORE PICTURES OF THIS SALE: <http://www.genecobbauction.com>**