

Real Estate Auction

COMMERCIAL BUILDING & ACREAGE IN ELK CITY, OKLA, RACING EQUIPMENT

SATURDAY, APRIL 27, 2019 10:00 A.M

SALE & PROPERTY LOCATION: 104 Griswold Swann, Elk City, Oklahoma

AUCTIONEER'S STATEMENT: It is a privilege to conduct the auction of this special commercial property and the racing equipment and supplies of Racer's Supply. We invite you to attend this special auction.

PROPERTY DESCRIPTION: The 3,200 sq. ft. metal frame commercial building built in 1982 located on .38 acres includes an office, display showroom, and a large shop. The property is surrounded by a chain link fence. The building has 2 large over head doors which provides good access to the building. The building offers numerous possibilities as a shop, warehouse, or a storage facility.

REAL ESTATE TERMS:

15% of the purchase price will be placed in escrow day of sale. Property will be conveyed by Warranty Deed.

Possession will be at closing.

All measurements are approximate.
(Selling surface only)

BROKER PARTICIPATION

INVITED: Broker must
pre-register client 48 hours
in advance of auction.

OPEN HOUSE

Sunday, April 14 & 21, 2019
from 1:00 to 3:00 p.m.

or by appointment 580-225-6743



REAL ESTATE SELLS AT 11:00 AM

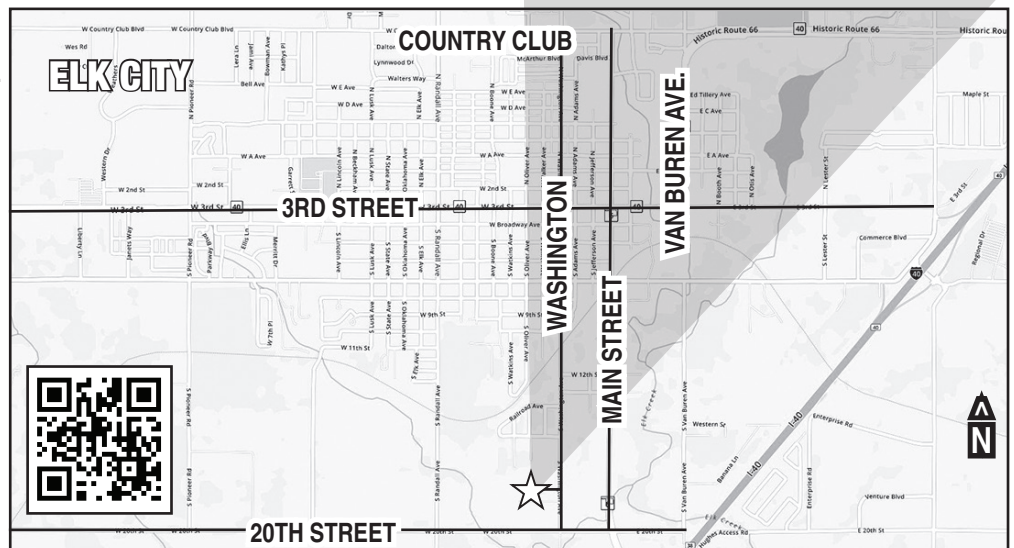

PERSONAL PROPERTY

VEHICLE LIFT

Magnum 4-post lift w/2 axle jacks

VEHICLES

2004 Ford F350 Super Cab, 2WD,
dually, 6.0 automatic, less than
36,000 actual miles

1987 Pontiac Grand Prix (metric)
(no title)

1998 Beckham trailer 28' (801/2"
between fenders)

RACING SUPPLIES & SHOP EQUIP.

3 - 9" Ford Yoke • Chassis jig
Elk City Factory Stock race car
5.83 9" pumpkin 31-spline mini-spool

9" pumpkin (build able)
32 - gallon fuel cell with tank
32 - gallon fuel cell bladder
3 - line Saginaw 3-speed transmission
Powerglide 2-speed trans. (good case)
Old style GM 3-speed cast-iron case
13 Scuffs (mixed) • 2 - Carburetor
Metric rotors, spindles, steering arms
Metric frame and roll-cage assembly
Misc. tires & wheels • Tubing notcher
1972 Chevelle jig fixtures
Pexto 52" Shear • Tubing rack
Welder plug extension cord
Tubing bender w/11/2" square + 1"
round + 11/4" round + 11/2" round +
13/4" round dies
Misc. flat and round tubing
Thermal Arc Model #210 mig welder

2 - Argon bottles
2 - Bottle jacks • Toe plates
Lincoln 225 arc welder
Powermax 1000 plasma cutter with cart
Large & Small torch kits with carts
Portable evaporative air conditioner -
5' (needs pump)
Stainless Steel table w/2 shelves -
351/2" w X 261/4" h X 771/4" l
Pedestal mounted vise • Sand blaster
Pedestal mounted grinder
Powermatic Drill press
Bump steer gauge
Daytona Drill press (needs motor)
Portapower (needs rebuilt)
Ford 9" assembly stand w/misc. parts &
shims
Coleman Powermate generator

Powerback generator (engine
good; generator might be bad)
Magna Force air compressor
Tire and wheel buggy
ATD chop saw • Rebo scales
Transmission jack
Mac Tools oil catch drain
Chief front end alignment turn
table set
Castor camber gauge
Ball joint kit tool
Engine lift plate
Heavy-duty grinder
Aluminum jack (needs rebuilt)
Ruff grooving gun
4' X 10' aluminum rack
Diesel space heater
much more to numerous to list



WILLIAM L. & SHARILYN NUTTALL & RACERS SUPPLY



Gene Cobb Auction & Realty

Richard E. Cobb, CAI, AARE • Auctioneer/Real Estate Broker • Certified Appraiser

580-225-6743 • P.O. Box 982 • Elk City, Oklahoma 73648

Rhett D. Cobb • Licensed Auctioneer • Real Estate Broker - Texas & Oklahoma

806-206-1554 • P.O. Box 763 • Canyon, Texas 79015 • Texas Broker # 0549348 • TDLR # 16204 • Oklahoma Broker # 142951

We Act As Agents & Agents Only • Not Responsible For Accidents • Any Announcements Made Sale Day Supersede All Other Announcements
Every effort has been made to assure the accuracy of the information with no guarantee of authenticity.

VISIT US ON THE WORLD WIDE WEB FOR A SCHEDULE OF UPCOMING AUCTIONS
AND TO VIEW MORE PICTURES OF THIS SALE: <http://www.genecobbauction.com>